

SMB 系列产品是按照 MIL-C-39012、IEC169-10 详细规范研制生产的一种小型推入锁紧式射频同轴连接器，具有体积小、质量轻、使用方便、电性能优良等特点，适用于无线电设备和电子仪器的高频回路中连接射频同轴电缆用。

The SMB series are snap-on-latched coupling miniature coaxial connectors which are produced according to the specifications of MIL-C-39012 and IEC 169-10. They have the characteristics of light weight, small size, convenient connection, excellent electrical and mechanical properties, are always suitable to connect coaxial cables in RF circuits of electronic equipment.

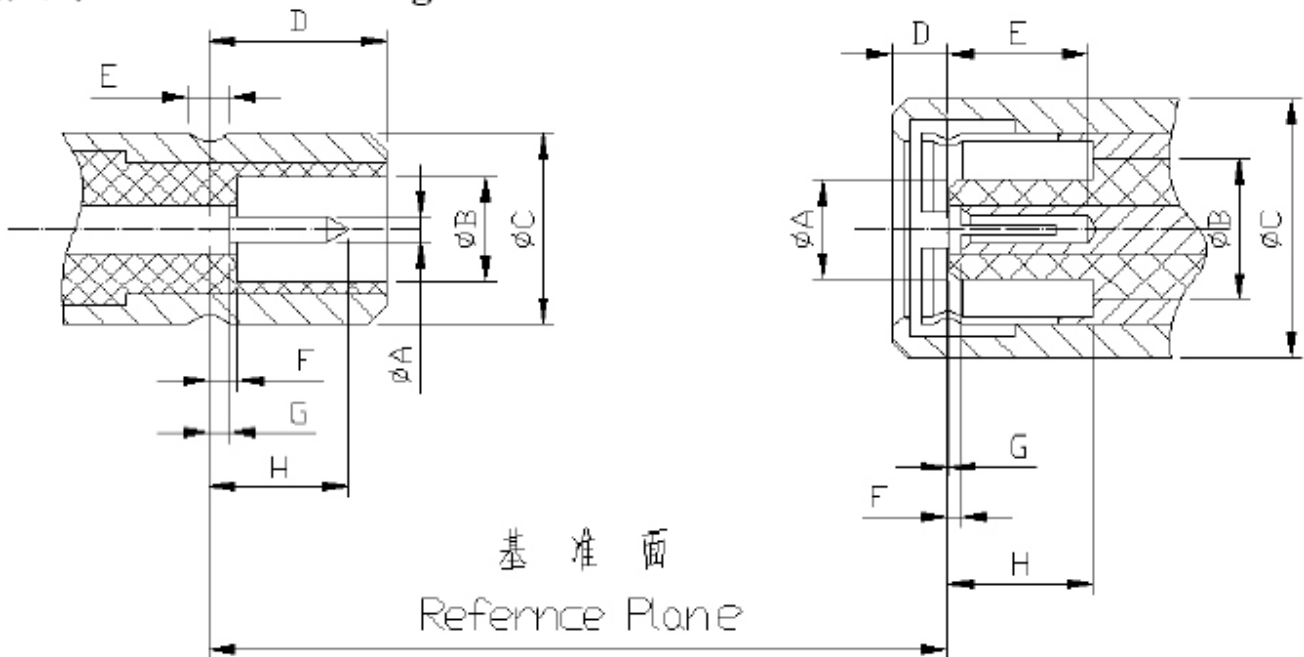

界面尺寸 Interface Mating Dimensions



	PLUG (mm)	
	MIN	MAX
A	0.48	0.53
B	2.08	-
C	3.66	3.71
D	3.33	3.58
E	0.69	0.94
F	-	0.18
G	-	0.18
H	-	2.97

	JACK (mm)	
	MIN	MAX
A	2	2.06
B	3.05	-
C	6.4	-
D	2.97	-
E	-	1.63
F	0.18	0.94
G	0.18	-
H	3.58	-

主要技术特性 Technical Characteristics:

环境温度范围 Temperature range	-65~+165℃	
电气性能 Electrical Characteristics		
特征阻抗 Characteristic impedance	50Ω	
工作电压 Working voltage	250V max(有效值)	
频率范围 Frequency range	0~4GHz	
介质耐压 Dielectric withstanding voltage	海平面 at sea level: 750V(volts RMS)	
接触电阻 Contact resistance	内导体 center contact	≤6.0mΩ
	外导体 Outer contact	≤1.0mΩ
绝缘电阻 Insulation resistance	≥5000MΩ	
电压驻波比 VSWR	直式 straight	≤1.34
	弯式 right - angle	
材料与涂覆 Mechanical Characteristics		
壳体和其它金属零件 Body or other metallic parts	黄铜镀金或镍 Brass, gold / nickel plated	
插针 Male center contacts:	黄铜镀金 Brass, gold plated	
插孔 Female center contacts:	铍青铜镀金 Beryllium copper, gold plated	
绝缘体 Insulators:	聚四氟乙烯 PTFE	
压接套 Crimp ferrules:	铜合金镀镍或镀金 Copper alloy, nickel or gold plated	
密封件 Sealing washer	硅橡胶 Silicone rubber	
连接器机械耐久性 Connector durability	500 次 Cycles	

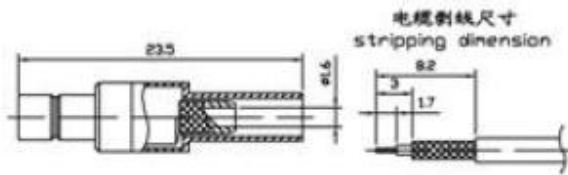

产品型号	电缆型号	备注
SMB-J3	SFF-50-1.5-1 RG316/U	

SMB-J3

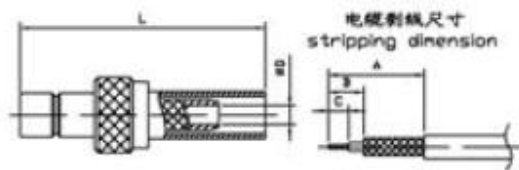

产品型号	电缆型号	D	L	A	B	C
SMB-J3A	SFF-50-1.5-1 RG316/U	01.6	21	11.0	4.5	2.5
SMB-J5A	SFF-50-3-2 RG223/U	03.1	23.7	13.0	5.5	2.5

SMB-J3A

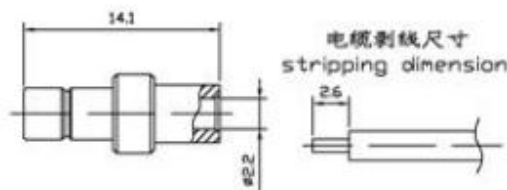

产品型号	电缆型号	备注
SMB-JB2	SFT-50-2-1 RG405/U	

SMB-JB2

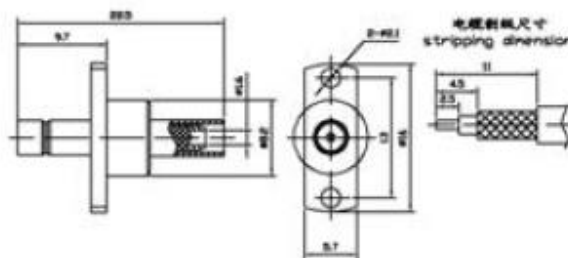

产品型号	电缆型号	备注
SMB-JF3A	SFF-50-1.5-1 RG316/U	

SMB-JF3A

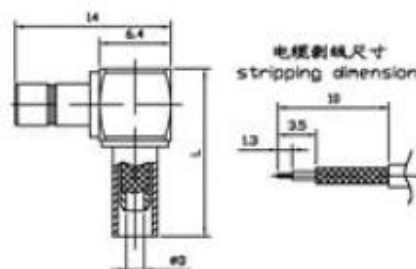

产品型号	电缆型号	D	L	A	B
SMB-JW2	SFF-50-1 RG178/U	13.7	00.9	10.0	3.5
SMB-JW3	SFF-50-1.5-1 RG316/U	15.1	01.6	11.0	5.0

SMB-JW2

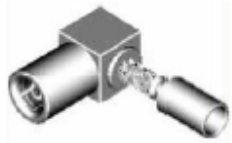

SMB-KW2

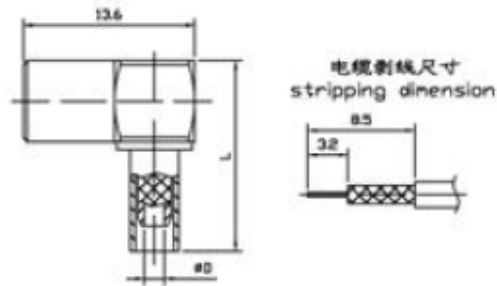

产品型号	电缆型号	D	L	备注
SMB-KW2	SFF-50-1 RG178/U	Ø0.9	13.7	
SMB-KW3	SFF-50-1.5-1 RG316/U SYV-50-2-1	Ø1.6	13.1	
SMB-KW4	SFF-50-2-1	Ø2.3	15.8	
SMB-KW5	SFF-50-3-1 SYV-50-3	Ø3.1	19.8	



SMB-KWB2

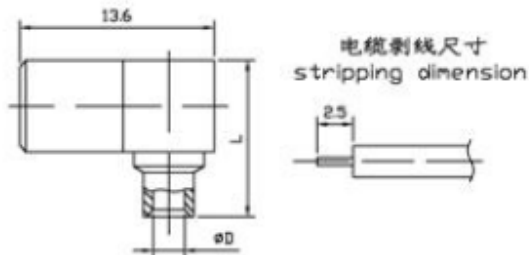

产品型号	电缆型号	L	D
SMB-KWB2	SFT-50-2-1 RG405/U	11.5	Ø2.2
SMB-KWB3	SFT-50-3-1 RG402/U	10.9	Ø3.6



SMB-KY3

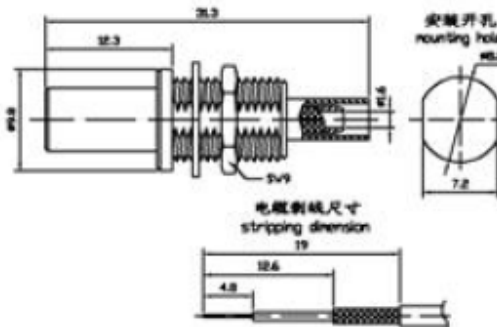

产品型号	电缆型号	备注
SMB-KY3	SFF-50-1.5-1 RG316/U	



SMB-JFD

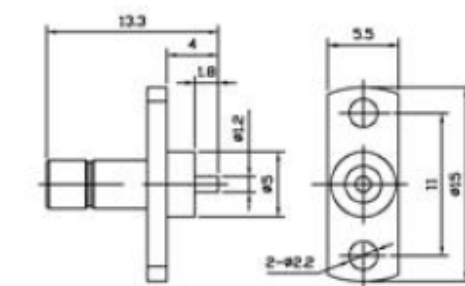

SMB-JFD21

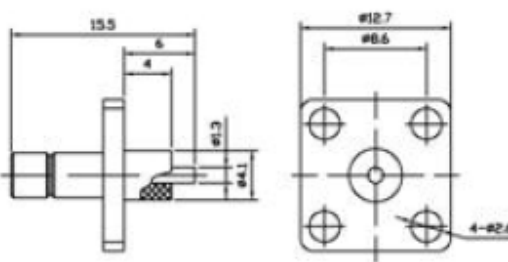



SMB-JFD21A

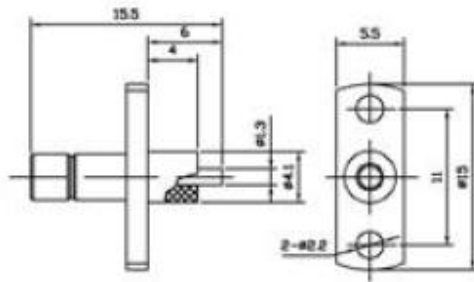

SMB-KFD

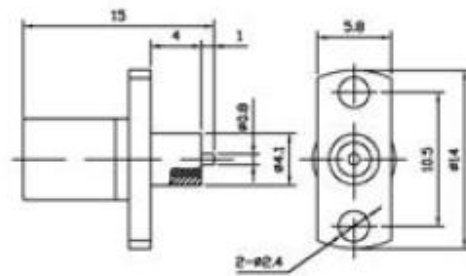

SMB-JYA

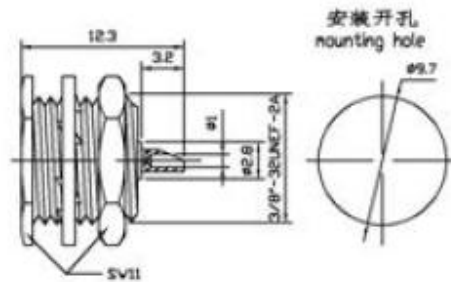

SMB-JYD

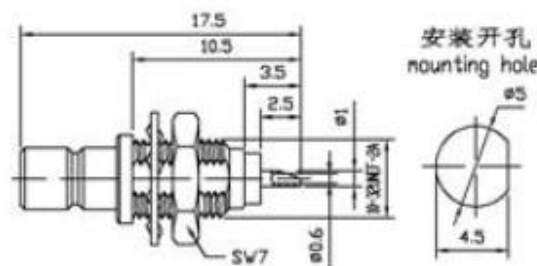

SMB-JHD

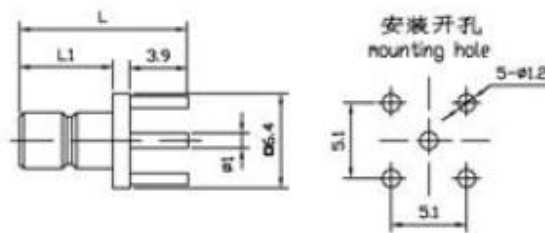

产品型号	L	L1
SMB-JHD	11.4	6.3
SMB-JHDA	10.7	5.6
SMB-JHD3	18.3	13.2
SMB-JHD4	13.7	8.6
SMB-JHD5	9.9	5.2



SMB-JJ

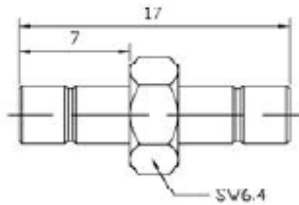

SMB-JJY

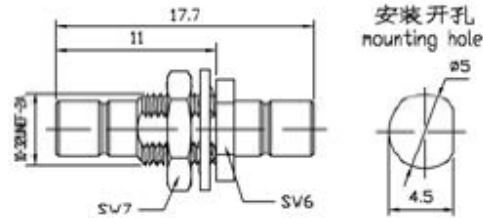

SMB-KJ

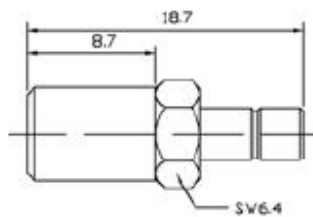

SMB-KK

