

MCX 小型插入自锁式连接器是按照 CECC22220 要求生产的体积、重量、耐用性及性能具佳的产品，其体积比标准的 SMB 小 30%，因而连接更紧密。适用于对体积、重量、性能及安装方式有特殊要求的领域。

The MCX series are snap-on coupling micro-miniature coaxial connectors which are developed according to the specifications of CECC22220. With the 30% smaller size than SMB connectors, they are sure to fit most applications where space, weight, performance and ease of assembly are required in RF circuits of communication instruments.

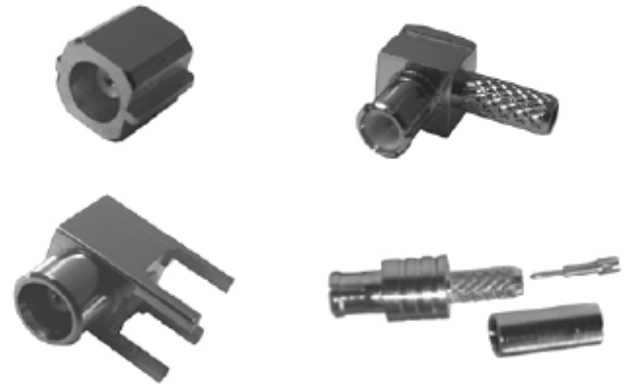

界面尺寸 Interface Mating Dimensions

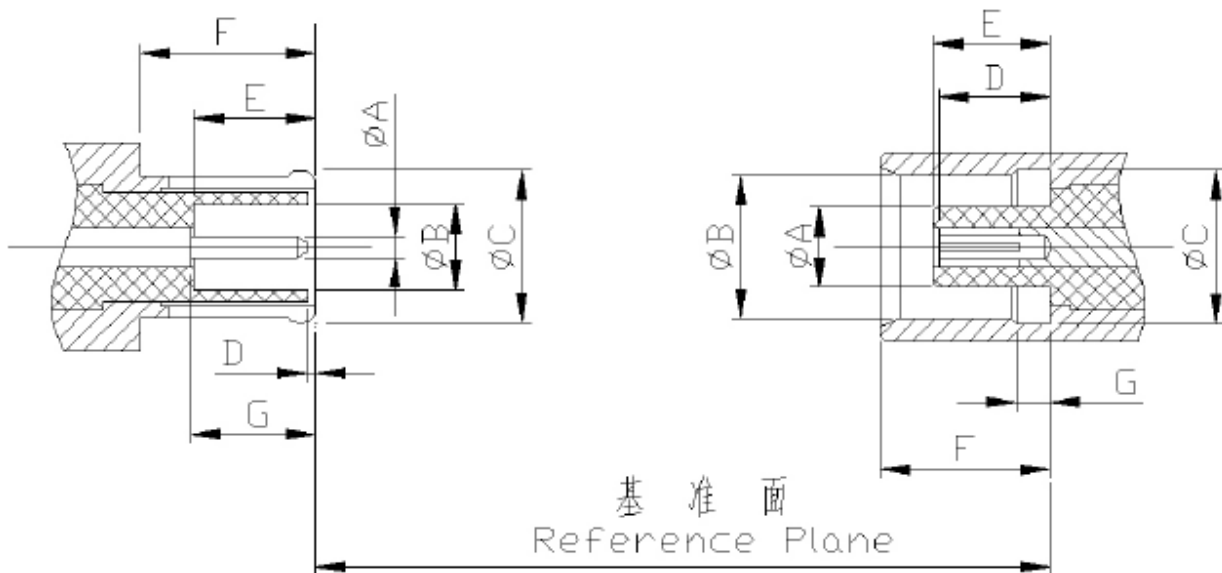

	PLUG (mm)	
	MIN	MAX
A	0.48	0.53
B	2.00	2.07
C	3.68	3.76
D	0.00	0.30
E	2.81	3.20
F	4.15	-
G	2.81	3.20

	JACK (mm)	
	MIN	MAX
A	1.80	1.97
B	3.43	3.48
C	3.61	3.75
D	2.31	2.79
E	2.61	2.79
F	4.00	4.12
G	0.75	0.85

主要技术特性 Technical Characteristics:

环境温度范围 Temperature range	-65~+165°C	
电气性能 Electrical Characteristics		
特征阻抗 Characteristic impedance	50Ω, 75Ω	
工作电压 Working voltage	500V max(有效值)	
频率范围 Frequency range	0~6GHz(50Ω); 0~1.5GHz(75Ω)	
介质耐压 Dielectric withstanding voltage	海平面 at sea level: 750V(volts RMS)	
接触电阻 Contact resistance	内导体 center contact	≤5.0mΩ
	外导体 Outer contact	≤2.5mΩ
绝缘电阻 Insulation resistance	≥1000MΩ	
电压驻波比 VSWR	直式 straight	≤1.20(50Ω); ≤1.35(75Ω)
	弯式 right - angle	
材料与涂覆 Mechanical Characteristics		
壳体和其它金属零件 Body or other metallic parts	黄铜镀金 Brass, gold plated	
插针 Male center contacts:	黄铜镀金 Brass, gold plated	
插孔 Female center contacts:	铍青铜镀金 Beryllium copper, gold plated	
绝缘体 Insulators:	聚四氟乙烯 PTFE	
压接套 Crimp ferrules:	铜合金镀镍或镀金 Copper alloy, nickel or gold plated	
密封件 Sealing washer	硅橡胶 Silicone rubber	
连接器机械耐久性 Connector durability	500 次 Cycles	



MCX-J2

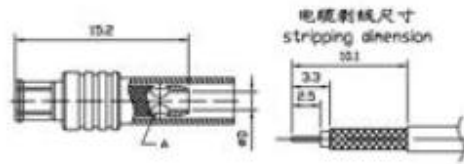

产品型号	电缆型号	D	备注
MCX-J2	SFF-50-1 RG178/U	Ø1.0	A 处打 Ø1.5 焊线孔
MCX-J3	SFF-50-1.5-1 RG316/U	Ø1.65	A 处无焊线孔



MCX-JB2

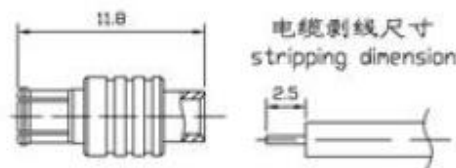

产品型号	电缆型号	D	备注
MCX-JB2	SFT-50-2-1 RG405/U	Ø2.2	
MCX-JB3	SFT-50-3-1 RG402/U	Ø3.6	

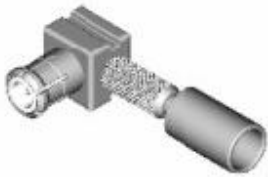

MCX-JW2

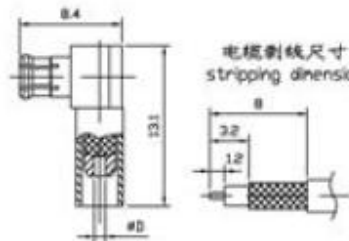

产品型号	电缆型号	D	备注
MCX-JW2	SFF-50-1 RG178/U	Ø0.9	
MCX-JW3	SFF-50-1.5-1 RG316/U	Ø1.6	



MCX-JWB2

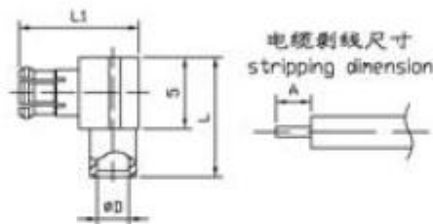

产品型号	电缆型号	D	L	L1	A
MCX-JWB2	SFT-50-2-1	Ø2.2	8.4	8.4	2.5
MCX-JWB3	SFT-50-3-1	Ø3.6	9.2	9.2	4.0



MCX-K2

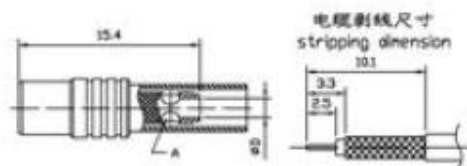

产品型号	电缆型号	D	备注
MCX-K2	SFF-50-1 RG178/U	Ø0.9	
MCX-K3	SFF-50-1.5-1 RG316/U	Ø1.6	

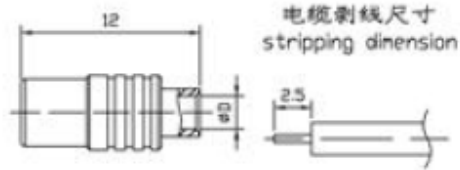

产品型号	电缆型号	D	备注
MCX-KB2	SFT-50-2-1 RG405/U	$\phi 2.2$	
MCX-KB3	SFT-50-3-1 RG402/U	$\phi 3.6$	

MCX-KB2

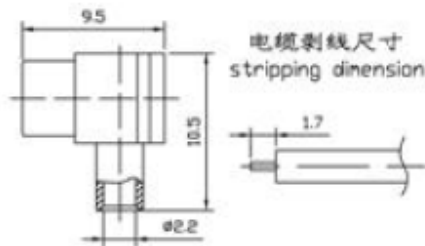

产品型号	电缆型号	备注
MCX-KWB2	SFT-50-2-1 RG405/U	

MCX-KWB2

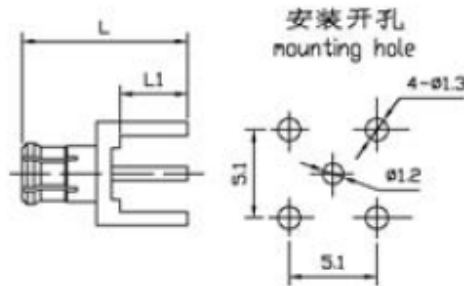

产品型号	L	L1	备注
MCX-JHD	9.6	3.9	
MCX-JHD1	8.6	2.9	
MCX-JHD2	7.8	2.3	

MCX-JHD

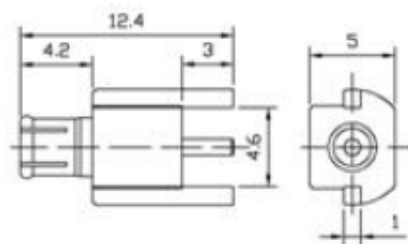

MCX-JH-PCB

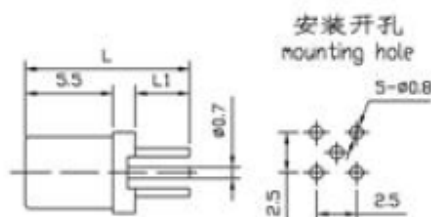
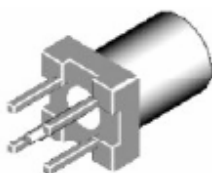

MCX-KHD9



MCX-KHD

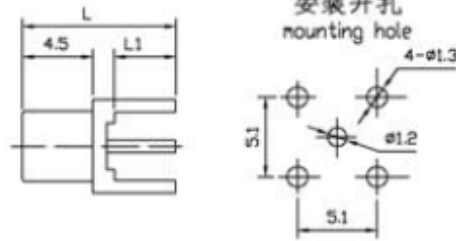

产品型号	L	L1	备注
MCX-KHD	8.3	2.4	
MCX-KHD1	9.3	3.4	
MCX-KHD2	7.1	1.2	
MCX-KHD3	11.3	3.9	
MCX-KHD4	10.1	3.5	
MCX-KHD7	8.6	2.6	
MCX-KHD10	12.5	2.7	

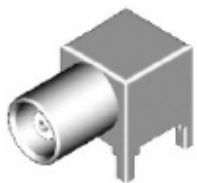

MCX-KWHD

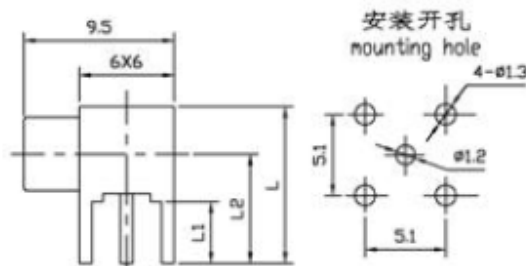

产品型号	L	L1	L2	备注
MCX-KWHD	7.7	1.7	4.7	
MCX-KWHD1	8.9	2.9	5.9	
MCX-KWHD2	9.9	3.9	6.9	



MCX-KFD

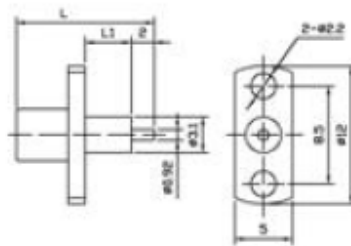

产品型号	L	L1	备注
MCX-KFD	10	2	
MCX-KFD1	12	4	
MCX-KFD2	16	8	

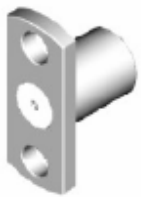

MCX-KF2

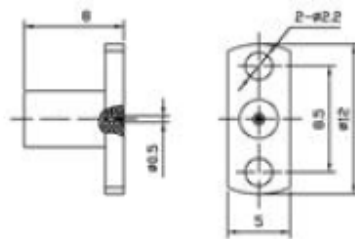

产品型号	备注
MCX-KF2	适配插针 $\varnothing 0.5^{+0.03}_{-0.02}$



MCX-KY

